

How to Play

[Betting](#)

[The Game](#)

[Card Values](#)

[A Blackjack](#)

[Play Options](#)

[Hand Signals](#)

[Terminology](#)

[Hard and Soft Hands](#)

Betting

At the outset of each hand, you place a bet in the white rectangle in the center of your screen. There are five ways in which you may place or retrieve your bet:

- 1) Drag the appropriate number of chips to or from the betting area using your mouse.
- 2) Double click on the chip denomination you wish to bet or retrieve.
- 3) Click on the appropriate bet amount in the Commands window.
- 4) Click on the arrows at the upper right corner of the bet box.
- 5) Type the bet amount into the amount area above your bet box.

After a hand wins or pushes (including split hands), chips won or retained can only be returned to your credit stacks. Clicking on Deal in the Commands window, or betting additional chips will cause all chips left on the table to center in the bet box for the next hand.

Note: clicking lower into a chip stack will allow you to drag multiple chips to or from the bet box.

Periodically you will see a symbol in the bet amount area. The cards will not be dealt when one of these symbols are present. These represent the following:

- your current bet is under the minimum bet amount.
- + your current bet is over the maximum bet allowed.
- > your current bet exceeds your current credit.

The Game

Every player and the dealer are initially dealt two cards each. Each player's hand is played against the dealer's hand only. If you obtain a hand value closer to twenty-one (without going over) than the dealer, you will win your hand.

You might conclude that the object of the game is to obtain a hand value as close to twenty-one as possible without going over. However, this is **NOT** true for the expert. His objective is simply to **Beat The Dealer!**

Card Values

Cards 2 - 10 a numerical value equal to the number printed on the card.

Face cards Jack, Queen and King have the value of ten.

Aces Aces may be counted as either eleven or one.

Hint:

Value of the Ace

Hint: Value of the Ace

The value of the ace seems to confuse some players under the "heat of the action". Always count the ace as eleven until a count of eleven will put your hand over twenty-one, then count the ace as one. Thinking of the ace in these terms will make adding your total card value easier.

A Blackjack

Blackjack - a hand with the value of twenty-one in the first two cards. This hand contains an ace and a ten valued card. A blackjack is the most powerful hand in the game of blackjack.

When you receive a blackjack, the dealer will pay you three chips for every two that you have bet unless the dealer also has a blackjack. When both you and the dealer have blackjacks, your bet is simply retained by you.

Play Options

<u>Hit</u>	Take another card.
<u>Stand</u>	Stop taking cards.
<u>Split</u>	An option available on a two card hand in which each card has equal value (a ten and a queen are cards of equal value). When you split your hand, an amount equal to your original wager will be anted and your hand split. You play two separate hands. Some casinos enforce restrictions on splitting a pair of aces or restrictions on doubling down on split hands.
<u>Double Down</u>	The double down option is only allowed on a two card hand. When doubling down, an amount equal to your original wager will be wagered, doubling your bet. You are dealt one additional card. Your hand is played using the three cards. Some casinos enforce double down restrictions.
<u>Surrender</u>	The surrender option is allowed on two card hands only. You give up half of your wager and surrender all chances of winning the hand.
<u>Insurance</u>	The insurance option is simply another form of wager that is offered to the players when the dealer has an ace showing. Those who take the insurance wager are betting that the dealer has a blackjack. The insurance bet costs one-half your original wager, and the payoff, should the dealer indeed have a blackjack, is two-to-one.

Terminology

Push	a hand value identical to dealer's, the bet is neither won nor lost,
Bust	a hand value over twenty-one, a losing hand
Hole Card	dealer's down card
Shoe	a plastic box that sits on the table from which the cards are dealt
Cut the Deck	insertion of a plastic card into a shuffled deck to determine the re-shuffle point
Burn	after a cut, dealer places 1 to 5 cards into the discard box before the deal
First Base	first position dealt, on dealer's immediate left
Third Base	last position dealt, on dealer's immediate right
Eye in the Sky	overhead electronic surveillance in the casinos

Related Topics:

[A Blackjack](#)

[Play Options](#)

[Hard and Soft Hands](#)

Hard and Soft Hands

When you have an ace in your hand that counts as eleven, you have what is known as a "soft hand". If you hold no aces or have an ace in your hand that counts as one, you have a "hard hand".

Hint:

[Remembering Hard and Soft Hands](#)

Hint: Remembering Hard and Soft Hands

Think of an ace in your hand as flexible or "soft" because the hand value can always be reduced. Whenever you have a soft hand, you hold a distinct advantage over the dealer. This is because you can never bust when you hit a soft hand.

Signaling Hit or Stand

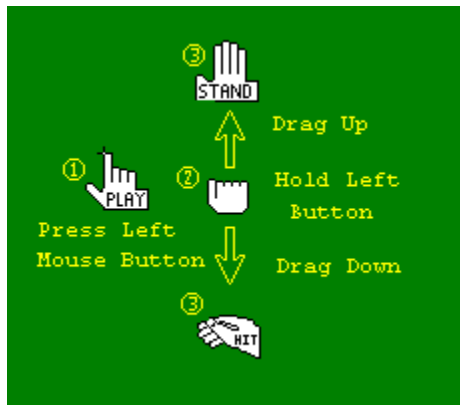

To signal a hit, hold the left mouse button down and drag the mouse toward you. To signal an intention to stand, hold the left mouse button down and push the mouse away from you. In either case, releasing the left mouse button completes the intended signal.

If you decide to change your mind before you release the left mouse button, you may do so. Continue holding the left mouse button down and drag the mouse in the opposite direction of the signal just indicated. When the hand cursor returns to its original form you may safely release the left mouse button or perform any other legal action.

The alternative to hand signals is to select hit or stand in either the commands window or the commands menu.

Signaling Split or Double Down

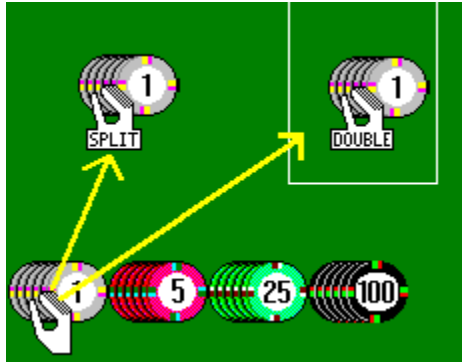

To signal a split or double down, click on the chip stacks immediately in front of you. The appropriate amount of chips will automatically be selected. When you have two cards of equal value, releasing the chips to the left or right of the bet box will signal the intention to split. Releasing the chips in the bet box will signal an intention to double down. Returning the chips you are holding to your chip stacks, before releasing the left mouse button, will allow you to reconsider.

The alternative to hand signals is to select split, or double down in either the commands window or the commands menu.

Signaling Surrender

To signal an intention to surrender you must either click on surrender in the commands window or the commands menu. There is no hand signal to signal surrender.

Signaling Insurance



To take insurance, click on the chip stacks immediately in front of you. Enough chips to cover the insurance bet will automatically be selected. Drag the insurance bet to the insurance semi-circle above the bet box and release the left mouse button.

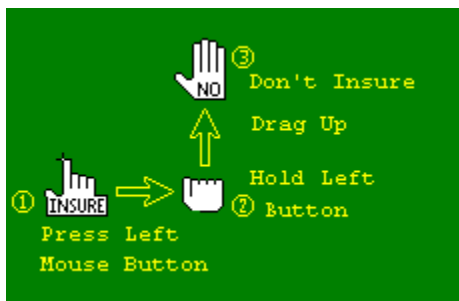

To decline insurance, hold the left mouse button down and push the mouse away from you. Releasing the left mouse button completes the intended signal.

Masque Blackjack for Windows

[Menu Commands](#)

[Keyboard](#)

[How To Play](#)

[Hand Signals](#)

Menu Commands

The menu bar is the standard Windows interface to all of the Masque Blackjack features. Click the mouse on the action you wish to access or depress the Alt key in conjunction with the underlined letter of the action.

Game Commands View Strategy Tables Strategy Deviations Training
Help

<u>G</u> ame	Game rules, and environment settings
<u>C</u> ommands	Blackjack game commands
<u>V</u> iew	Controls screen display options
<u>S</u> trategy Tables	Allow viewing of the expert strategy tables
<u>S</u> trategy <u>D</u> eviations	Allow viewing of the strategy errors you have made
<u>T</u> raining	Access to additional tutorial features of the game
<u>C</u> D Player	Play any of your favorite music CDs in your computer CD-ROM player
<u>H</u> elp	Provides access to Help topics, and information about this version of Masque Blackjack

Related Topics:

[Card Counting Drills](#)
[Your Play Results](#)

[Strategy Drills](#)
[Expert Play Simulation](#)

Game Menu

Rules	Clicking on Rules in the Game menu will bring up a dialog box which will allow you to select the strategy you wish to master, set the house rules and game parameters.
Environment	The Environment selection displays a dialog box which allows you to customize your game playing environment. These include program timing, message displays, error warnings, sounds and right mouse button functionality.
Save Settings	Clicking on Save Settings will save all programmable options such as strategy selections, rules, game parameters and environment choices. These will become the default settings for this and any subsequent sessions of Masque Blackjack.
About Blackjack	This option gives you program information about Masque Blackjack for Windows.
Exit Blackjack	Exits from Masque Blackjack. You will be presented with a dialog box asking you whether you want to save the current settings. Selecting <i>YES</i> will save the current settings as the default, <i>NO</i> will leave the default settings as they were when last set and choosing <i>CANCEL</i> will allow you to continue playing Masque Blackjack.

Commands Menu

The blackjack playing decisions may be selected through the Commands Menu, however, these are more readily accessed through the Commands Window, a movable, re-sizable window on your playing table (see also *View Menu, Commands* option).

Each of the options in the Commands Menu may be accessed via the keyboard accelerator key noted to the right of each command.

View Menu

The View Menu has a number of settings which are represented by a check mark. When checked an item is visible on the viewing screen. Those items not represented by a check mark have multiple settings which are presented in a sub-menu.

Commands	Allows you to make the blackjack playing commands visible in a moveable, re-sizable window on your playing screen.
Player Credit	The player credit window is a moveable window which shows the credit you have remaining.
Recommendation	The moveable Recommendation window shows the expert play recommendation for your situation.
Hand Value	Hand value is the total value of the hand showing. It is located to the left of the hand it represents.
Card Count	A sub-menu will appear, allowing you to choose your desired setting, <i>Full</i> , <i>Decks Left</i> or <i>Off</i> . The Full card count window shows the current true count as well as the card count history since the last shuffle. Decks Left shows only the number of decks remaining to be dealt. The accelerator key, ^C, will allow you to toggle from one display to the other.
Odds	The odds window is moveable and capable of presenting three types of odds calculations, <i>Your Next Card</i> , <i>General Dealer</i> , <i>Dealer Holds</i> , and <i>Off</i> . These calculations are the probabilities for your next card draw, what the dealer will end up with when he starts out with his present up card and what the dealer's current two card hand value is. The accelerator key, ^O, will allow you to toggle from one display to the other.

Strategy Tables

The Strategy Tables menu choices allow you to view any of the expert strategy tables. Each of these selections has an accelerator key selection, to the right of each command, allowing direct keyboard access from your playing screen. Any selection displays the corresponding expert strategy table.

Draw and Stand	Surrender
Double Down	Insurance
Split	Bet

Recommended Choosing *Recommended* will instruct the computer to select the appropriate strategy table for your viewing.

Note: The draw / stand and double down strategy tables have both a hard hand and a soft hand strategy table. When you are between playing hands, (before the cards are dealt for a new hand), both tables will appear. When you are faced with a strategy decision, only the appropriate table, depending on whether your hand is hard or soft, will appear.

Related Topics:

[Strategy Deviations](#)

[Hard Hands / Soft Hands](#)

Strategy Deviations

When you do not follow the expert play recommendation, it is classified as a strategy deviation. Your strategy deviations are recorded for your review. Click on this selection to view the deviations you have made.

The Strategy Deviations menu choices allow you to view all the instances where you did not follow the expert strategy recommendation. The strategy deviation tables are very similar to the corresponding expert strategy tables. The difference is, instead of a completed expert strategy table, the only tiles marked are those for which your play during this session deviated from the expert strategy of play. Any blank tile grids indicate that you either played the given situation correctly each time or that the situation did not present itself during this session.

You have two options for recording your deviations. To modify your options, refer to the [Games Menu - Environment](#) selection. One option is to mark only the table that you should have followed. The second allows marking both the table you should have followed and the table that you did follow.

An example of two tables being marked: the correct strategy for a hand of 8,8 vs a dealer 8 is to split. If you select draw, both the split and hard hand draw tables will be marked as a strategy deviation. However, if you had chosen to double down, only the split table will be marked. The double down hard hand table has no grid which accommodates such a situation.

Related Topics:

[Strategy Tables](#)

[Hard Hands / Soft Hands](#)

CD Player

You may play any of your favorite music CDs in your computer's CD-ROM drive while you enjoy your game. If a CD-ROM drive is present on your system, you will be able to select the *CD Player...* menu item.

Once selected, you may place the CD Player dialog box anywhere on your screen by dragging the CD Player Title Bar to the desired screen location. Clicking on the *System-Menu* box, in the upper left corner of the CD Player dialog, allows you to move, close or alter the dialog box appearance.

Status	shows the current CD track, the total number of CD tracks and the elapsed time into the current track.
Buttons	makes the CD play, stop, previous track, next track and eject control buttons visible.
No Title	shrinks the dialog box by eliminating the Title Bar. Double-clicking on a blank area of the dialog box will cause the Title Bar to re-appear.
Small Buttons	shrinks the dialog box by making the control buttons smaller.

Help

The Help Menu includes the following selections:

<u>Be a Winner</u>	Gives you tips on a systematic approach to quickly becoming an expert player.
<u>Strategy Origins</u>	Credits the author of the Masque Blackjack strategies, Julian Braun.
Index	Selecting this option will give you an index of all available categories for which you may obtain help.
Menu Commands	Selecting the Commands option will give you a listing of available Masque Blackjack commands.
Keyboard	Gives you help with the keyboard commands.
how to play	The How to Play option will offer help on how to play.
Using Help	Explains how to use the Windows help system.

Be A Winner

Mastering blackjack involves acquiring a winning blackjack strategy, learning it and following its advice religiously. Your learning process will prove most beneficial to you if you learn the strategy in the order of your greatest theoretical advantage. That play strategy order is:

- 1) Draw/Stand Strategy
- 2) Hard Double Down Strategy
- 3) Split Strategy
- 4) Soft Double Down Strategy
- 5) Surrender Strategy

Augment this with a simple method of counting cards. Once card counting is mastered, take full advantage of the winning strategy potential by implementing the:

- 6) Bet Strategy
- 7) Insurance Strategy
- 8) Point Count Strategy"

The order of strategy decision making is constant for all situations. Always consult the strategy decision charts in the following order:

- 1) Surrender Strategy
- 2) Split Strategy
- 3) Double Down Strategy
- 4) Draw/Stand Strategy"

"Masque has even gone a step further than Thorp and Braun in their statistical analyses of the game. Their manual is one of the best books ever written on the game of blackjack!", Carlos Perez, a noted Vegas gambler, author and free-lance writer.

The manual that accompanies this software explains the strategies, helpful card counting tips, an explanation of the game and statistical analysis, the set of common blackjack rules most favorable to the player, common rule variation advantages and disadvantages and numerous suggestions to further improve your game and winnings.

Sure it's fun to play, but take the time to read the manual. The more fully you understand your blackjack strategy and its reasoning, the easier it will be for you to master it!

Strategy Origins

All strategies and dealer probability calculations were formulated by **Julian H. Braun**, M.S., Formerly of IBM Corporation, Julian is widely recognized as one of the world's foremost experts on blackjack probability and strategy analysis. He has been quoted in numerous articles and his accomplishments have often been cited by many other blackjack strategy authors. His research of over 18 years has culminated in the development of the world's most powerful, easy to use blackjack strategies available. His works, presented to you in computerized form, provide you with the proof, the means and power to master blackjack in a most effective, efficient manner.

Card Counting Drills

Card Counting gives the advanced blackjack player an increasing edge against the dealer in the form of altering the basic game playing strategy, the betting strategy and the insurance strategy in agreement with the ever changing deck composition. The card counting drills feature has two menus *Practice* and *Options* which include the following choices:

Begin Card Counting	Start the card counting session.
Abort this round	There will be times when you need to suddenly interrupt your practice session, perhaps when your option settings are not to your liking. This selection does not exit the card counting feature, it simply ends the current round of card counting. This option can only be selected when a card counting practice session is in progress.
Quit Card Counting	To exit the card counting feature, click on this option.
Exit Blackjack	Select Exit Blackjack to leave the Masque Blackjack game. You will be presented with a dialog box asking you whether you want to save the current settings. Selecting YES will save the current settings as the default, NO will leave the default settings as they were when last set and choosing CANCEL will allow you to continue playing Masque Blackjack.
Options	presents you with a dialog box which allows you to set the card count window display, the number of decks to practice with, the time interval between cards dealt and the number of player hands that are being dealt. A full card count display window is automatically visible after all decks have been dealt, allowing a full review of the card counting round.

Strategy Drills

The Strategy Drills Menu Bar gives you an overview of the of the strategy practice features of Masque Blackjack. This feature is important to your blackjack playing skill development. To gain a positive edge against the house you need to know the finer aspects of winning blackjack strategies.

Under regular play, a number of "tricky" situations may never occur. Under strategy practice, the 102 blackjack hands most likely to trip you up in real play will each be given once in a random order. Some of these situations may seem simple at first, but when a surrender rule is allowed they become one of those tricky situations. If you do not score consistently high on the strategy practice feature of this game, don't bet too much in the casinos!

The Strategy Practice Menu Bar includes the following menus:

<u>Game</u>	Game rules, and environment settings
<u>Commands</u>	Blackjack game commands
<u>View</u>	Controls screen display options
<u>Strategy Tables</u>	Allow viewing of the expert strategy tables
<u>Strategy Deviations</u>	Allow viewing of the strategy errors you have made

Practice

Practice Options	Practice Options presents you with a dialog box that allows you to turn the hand value display <i>On/Off</i> and set the type of warnings you will get when you deviate from the expert strategy of play.
Rules	Allows you to determine which of the four strategies you wish to be drilled on and set the house rules that will affect your strategy of play. The only rule settings that affect correct strategy of play are the double down restrictions, the form of surrendering allowed and whether doubling down is permitted after splitting.
Quit Practice	To exit the strategy practice drill feature, click on this option.
Exit Blackjack	Select Exit Blackjack to leave the Masque Blackjack game. You will be presented with a dialog box asking you whether you want to save the current settings. Selecting <i>YES</i> will save the current settings as the default, <i>NO</i> will leave the default settings as they were when last set and choosing <i>CANCEL</i> will allow you to continue playing Masque Blackjack.

Commands

The blackjack playing decisions may be selected through the Commands Menu, however, these are more readily accessed through the Commands Window, a movable, re-sizable window on your playing table (see also *View Menu, Commands* option).

Each of the options in the Commands Menu may be accessed via the keyboard accelerator key noted to the right of each command.

View

The View Menu has settings which are represented by a check mark. When checked an item is visible on the viewing screen. Those items not represented by a check mark have multiple settings which are presented in a sub-menu.

Commands	Allows you to make the blackjack playing commands visible in a moveable, re-sizable window on your playing screen.
Recommendation	The moveable Recommendation window shows the expert play recommendation for your situation.
Hand Value	Hand value is the total value of the hand showing. It is located to the left of the hand it represents.

Strategy Tables

The Strategy Tables menu choices allow you to view any of the expert strategy tables. Each of these selections has an accelerator key selection, to the right of each command, allowing direct keyboard access from your playing screen. Any selection displays the corresponding expert strategy table.

Draw and Stand	Surrender
Double Down	Insurance
Split	Bet

Recommended Choosing *Recommended* will instruct the computer to select the appropriate strategy table for your viewing.

Note: The draw / stand and double down strategy tables have both a hard hand and a soft hand strategy table. When you are between playing hands, (before the cards are dealt for a new hand), both tables will appear. When you are faced with a strategy decision, only the appropriate table, depending on whether your hand is hard or soft, will appear.

Strategy Deviations

When you do not follow the expert play recommendation, it is classified as a strategy deviation. Your strategy deviations are recorded for your review. Click on this selection to view the deviations you have made.

The Strategy Deviations menu choices allow you to view all the instances where you did not follow the expert strategy recommendation. The strategy deviation tables are very similar to the corresponding expert strategy tables. The difference is, instead of a completed expert strategy table, the only tiles marked are those for which your play during this session deviated from the expert strategy of play. Any blank tile grids indicate that you either played the given situation correctly each time or that the situation did not present itself during this session.

You have two options for recording your deviations. To modify your options, refer to the [Practice Menu - Environment](#) selection. One option is to mark only the table that you should have followed. The second allows marking both the table you should have followed and the table that you did follow.

An example of two tables being marked: the correct strategy for a hand of 8,8 vs a dealer 8 is to split. If you select draw, both the split and hard hand draw tables will be marked as a strategy deviation. However, if you had chosen to double down, only the split table will be marked. The double down hard hand table has no grid which accommodates such a situation.

Your Play Results

Your Play Results allows you to view a statistical compilation of how well you are doing.

Expert Play Simulation

The Expert Play Simulation allows you to select the strategy, the table rules and parameters, then have the computer quickly simulate expert strategy play. The ensuing statistical results will allow you to test and analyze any of the Masque Blackjack strategies. This gives you a unique and thorough opportunity to see the strengths of the blackjack strategies presented in the Masque Blackjack game. An entire chapter of your manual, *The Expert Play Simulation Analysis* explains the meaning of and importance each of its statistics.

Begin Simulation	Start the computer simulation of expert strategy play.
Options	Simulation options allow you to determine the number of hands played between statistic updates, the interval between cards and the maximum number of hands to play in the simulation run.
Rules	Allows you to determine which of the four strategies you wish to test, the house rules and game parameters.
Stop Simulation	To halt the expert play simulation, click on stop simulation.
Quit Practice	To exit the expert play simulation feature, click on this option.
Exit Blackjack	Select Exit Blackjack to leave the Masque Blackjack game. You will be presented with a dialog box asking you whether you want to save the current settings. Selecting <i>YES</i> will save the current settings as the default, <i>NO</i> will leave the default settings as they were when last set and choosing <i>CANCEL</i> will allow you to continue playing Masque Blackjack.

Expert Play Simulation View

Each of the View Menu options are *On/Off* selections denoted by a check mark. The items checked are visible on the viewing screen. Those items include:

Cards	Allows you to make the simulation cards visible while the simulation is run. The interval between which the cards are displayed is an Option set from the Expert Simulation Play menu.
Statistics	Shows the simulation statistics as the simulation is run. The update frequency of the statistics is determined by an Option setting in the Expert Simulation Play menu.
Hands & Credit	When Hands & Credit is selected, the number of simulation hands played and the current simulation credit are displayed.

Training

The Training Menu selections allow you to access features of Masque Blackjack which are designed to quickly improve various aspects of your playing ability. These include:

<u>Card Counting Drills</u>	Card counting practice drills can improve your card counting ability and confidence. Cards are displayed at user programmable time intervals that can challenge any level of ability.
<u>Strategy Drills</u>	Playing a round of blackjack does not guarantee that you will be faced with all of the difficult decision hands. Strategy practice drills will give each of 102 borderline decisions once in a random order and grade your results. Your accuracy is displayed and the strategy errors you make are recorded for your review.
<u>Your Play Results</u>	This selection allows you to view a statistical evaluation of how well you are doing.
<u>Expert Play Simulation</u>	The Expert Play Simulation allows you to select the strategy, set the table playing conditions and have the computer quickly play a user programmable number of hands like an expert. The ensuing results are tabulated statistically, showing you the value of and true strengths of the expert strategy (see also the chapter titled <i>The Expert Play Simulation Analysis</i> in the manual).

Masque Blackjack Keys

Key(s)	Function
F1	Gets Help and displays the Help Index for Masque Blackjack. If the Help window is already open, pressing F1 displays the "Using Windows Help" topics.

Accelerator Keys	Function
Ctrl+T	Display the Draw / Stand strategy tables.
Ctrl+D	Display the Double Down strategy tables.
Ctrl+S	Display the Split strategy table.
Ctrl+U	Display the Surrender strategy table.
Ctrl+I	Display the Insurance strategy table.
Ctrl+B	Display the Betting strategy table.
Ctrl+R	Display the Recommended strategy table.